

# Tuffaloy tip adapters

TUFFALOY threaded electrode adapters are used to provide longer electrode holder life, by providing a changable tip socket in holders having threaded openings. Class 2 alloy.

A Pipe Thread or Taper	B Taper Socket	C Body Size	D Body Length	E Over-All Length	Descrip- tion	Item Number			
1/2	4RW	1" Hex	1/4	7/8	AD-124-.8	190-1408			
			3/8	1	AD-124-1.0	190-1410			
			5/8	1-1/4	AD-124-1.2	190-1412			
			7/8	1-1/2	AD-124-1.5	190-1415			
			1-1/8	1-3/4	AD-124-1.7	190-1417			
			1-3/8	2	AD-124-2.0	190-1420			
			1-5/8	2-1/4	AD-124-2.2 *				
			1-7/8	2-1/2	AD-124-2.5	190-1425			
			2-1/8	2-3/4	AD-124-2.7 *				
			2-3/8	3	AD-124-3.0	190-1430			
			2-5/8	3-1/4	AD-124-3.2 *				
			2-7/8	3-1/2	AD-124-3.5	190-1435			
			3-1/8	3-3/4	AD-124-3.7 *				
			3-3/8	4	AD-124-4.0	190-1440			
4-3/8	5	AD-124-5.0 *							
1/2	5RW	1" Hex	1/4	7/8	AD-125-.8	190-1508			
			3/8	1	AD-125-1.0	190-1510			
			5/8	1-1/4	AD-125-1.2	190-1512			
			7/8	1-1/2	AD-125-1.5	190-1515			
			1	1-5/8	AD-125-1.6 *				
			1-1/8	1-3/4	AD-125-1.7	190-1517			
			1-3/8	2	AD-125-2.0	190-1520			
			1-5/8	2-1/4	AD-125-2.2 *				
			1-7/8	2-1/2	AD-125-2.5	190-1525			
			2-1/8	2-3/4	AD-125-2.7 *				
			2-3/8	3	AD-125-3.0	190-1530			
			2-5/8	3-1/4	AD-125-3.2 *				
			2-7/8	3-1/2	AD-125-3.5	190-1535			
			3-1/8	3-3/4	AD-125-3.7 *				
			3-3/8	4	AD-125-4.0	190-1540			
			3-7/8	4-1/2	AD-125-4.5	190-1545			
			5/8	4RW	1" Hex	1/4	7/8	AD-584-.8	190-2408
						3/8	1	AD-584-1.0 *	
7/8	1-1/2	AD-584-1.5 *							
1-3/8	2	AD-584-2.0 *							
5/8	5RW	1" Hex	1/4	7/8	AD-585-.8	190-2508			
			3/8	1	AD-585-1.0 *				
			5/8	1-1/4	AD-585-1.2	190-2512			
			7/8	1-1/2	AD-585-1.5	190-2515			
			1-1/8	1-3/4	AD-585-1.7	190-2517			
			1-3/8	2	AD-585-2.0 *				
			1-7/8	2-1/2	AD-585-2.5 *				
			2-3/8	3	AD-585-3.0 *				
3-3/8	4	AD-585-4.0 *							
3/4	5RW	1.25	3/16	1-1/8	AD-345-1.1 *				
			7/16	1-3/8	AD-345-1.3 *				
			9/16	1-1/2	AD-345-1.5	190-3515			
			13/16	1-3/4	AD-345-1.7	190-3517			
			1-1/16	2	AD-345-2.0	190-3520			
			1-9/16	2-1/2	AD-345-2.5	190-3525			
			2-1/16	3	AD-345-3.0	190-3530			
			2-9/16	3-1/2	AD-345-3.5	190-3535			
			3-1/16	4	AD-345-4.0	190-3540			
			4-1/16	5	AD-345-5.0	190-3550			
3/4	6RW	1.25	5/16	1-1/4	AD-346-1.2 *				
			7/16	1-3/8	AD-346-1.3 *				
			9/16	1-1/2	AD-346-1.5	190-3615			
			1-1/16	2	AD-346-2.0	190-3620			
			1-9/16	2-1/2	AD-346-2.5	190-3625			
			1-13/16	2-3/4	AD-346-2.7 *				
			2-1/16	3	AD-346-3.0	190-3630			
			2-9/16	3-1/2	AD-346-3.5	190-3635			
			3-1/16	4	AD-346-4.0	190-3640			
			3-9/16	4-1/2	AD-346-4.5	190-3645			
4-1/16	5	AD-346-5.0	190-3650						
3/4	7RW	1.25	9/16	1-1/2	AD-347-1.5	190-3715			
			1-1/16	2	AD-347-2.0	190-3720			
			1-9/16	2-1/2	AD-347-2.5	190-3725			
			2-1/16	3	AD-347-3.0	190-3730			
			2-9/16	3-1/2	AD-347-3.5	190-3735			
			3-1/16	4	AD-347-4.0	190-3740			
3-9/16	4-1/2	AD-347-4.5	190-3745						
4-1/16	5	AD-347-5.0	190-3750						
4RW	5RW	7/8	1	2	AD-45-2	190-4520			
			2	3	AD-45-3	190-4530			
			3	4	AD-45-4	190-4540			
5RW	4RW	7/8	1/4	1-1/8	AD-54-1	190-5410			
			1	2	AD-54-2	190-5420			
			1-1/2	2-1/2	AD-54-2.5 *				
			2	3	AD-54-3	190-5430			
3	4	AD-54-4	190-5440						
5RW	5RW	7/8	1	2	AD-55-2	190-5520			
			1-1/2	2-1/2	AD-55-2.5 *				
			2	3	AD-55-3 *				
			3	4	AD-55-4 *				
			4	5	AD-55-5	190-5550			
5RW	6RW	1" Hex	1-1/8	2	AD-56-2	190-5620			
			1/4	1-1/4	AD-64-1	190-6410			
			1/4	1-1/4	AD-65-1	190-6510			
			1/4	1-1/2	AD-74-1	190-7410			
7RW	5RW	1" Hex	1/4	1-1/2	AD-75-1	190-7510			
			3/4	2	AD-75-2	190-7520			
			2-1/4	3-1/2	AD-73-3.5 *				
			2-3/4	4	AD-75-4 *				

\* Not commonly stocked - other adapters available upon request

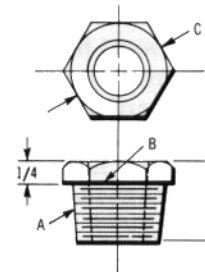

AD-124-.8, AD-125-.8,  
AD-584-.8, AD-585-.8

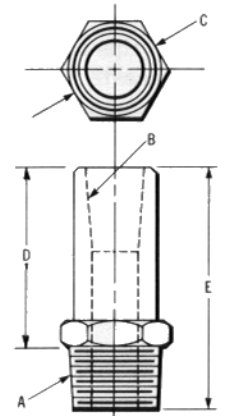

AD-124-1.0 to AD-124-4.0  
AD-125-1.0 to AD-125-4.0  
AD-345-1.5 to AD-347-5.0

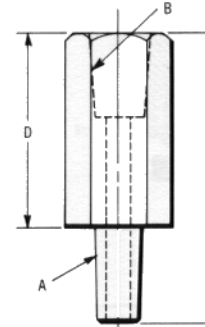

AD-45-2 to AD-45-4

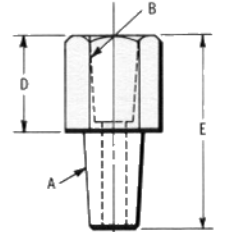

AD-54-1 to AD-75-2

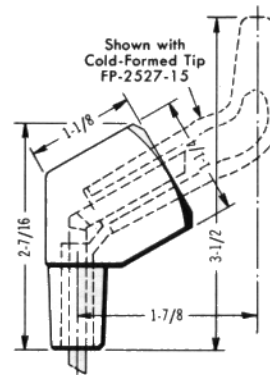

AD-55-30, for 5 RW Tip,  
Item No. 190-9553

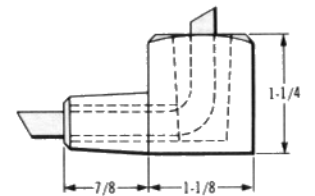

AD-55-90, for 5 RW Tip,  
Item No. 190-9559  
AD-54-90, for 4 RW Tip,  
Item No. 190-9549

AD-785-90E for 5 RW Tip,  
Item No. 190-9591

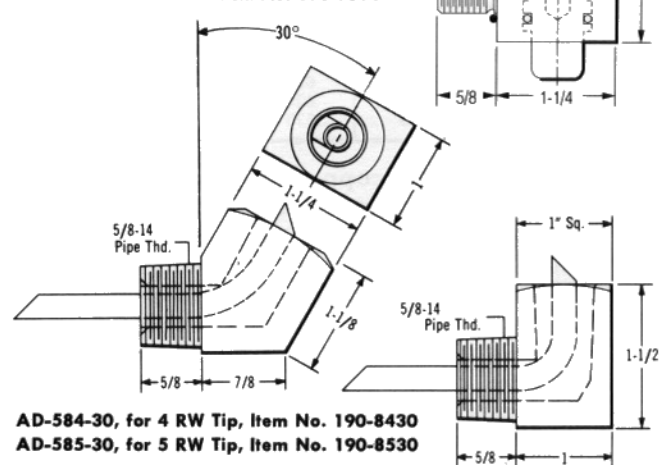

AD-584-30, for 4 RW Tip, Item No. 190-8430  
AD-585-30, for 5 RW Tip, Item No. 190-8530

AD-584-90, for 4 RW Tip, Item No. 190-8490  
AD-585-90, for 5 RW Tip, Item No. 190-8590